



6680 Southpoint Parkway



Garnett Commercial Real Estate, Inc.
7807 Baymeadows Road East
Suite 405, Jacksonville, FL 32256
904-855-8800
jgarnett@ccim.net
www.jackgarnett.com
Florida Licensed Real Estate Broker



GARNETT
COMMERCIAL
REAL ESTATE, INC.

**OFFICE SPACE
FOR SUB-LEASE**

6680 Southpoint Pkwy.

38,484 Total SF

2 Separate Suites

30,070 SF / 8,414 SF



PARKWAY PLACE
6680 Southpoint Parkway
Jacksonville, Florida 32216

Building Type/Size:	Single Story Office Building totaling 56,460 SF.
Location:	Located Southpoint Business Park, with easy access to Butler Blvd., Interstate 95 and Interstate 295. Close to the popular Tinseltown and St. Johns Town Center Retail Areas.
Sublease Space Sizes:	30,070 SF Call Center Space with 336 Seats. <u>8,414 SF Call Center Space with 100 Seats.</u> 38,484 SF Total Sublease Space Available.
Available Term:	Current Lease/Sublease Term Expires June 30, 2025.
NNN Base Rent:	\$10.00 psf NNN.
CAM Charges:	\$4.91psf (includes Electric).
Tenant Direct Expenses:	Janitorial and Communications expenses.
Parking:	Free abundant parking adjacent to the Building and exclusive to this Project. Parking Ratio of 7 spaces per 1,000 SF.
Signage:	Exterior Building Monument Signage available at Sub-Tenant's expense. Subject to Landlord approval.
In Place Furniture:	Most of the office furniture, open landscape furniture systems and equipment can be left in place for Sub-Tenant's use.

Garnett Commercial Real Estate, Inc.
7807 Baymeadows Road East, Suite 405, Jacksonville, FL 32256
904-855-8800 / jgarnett@ccim.net / www.jackgarnett.com

Disclaimer: Details herein are believed to be correct; however, it is subject to errors, omissions, price change or withdrawal without notice.

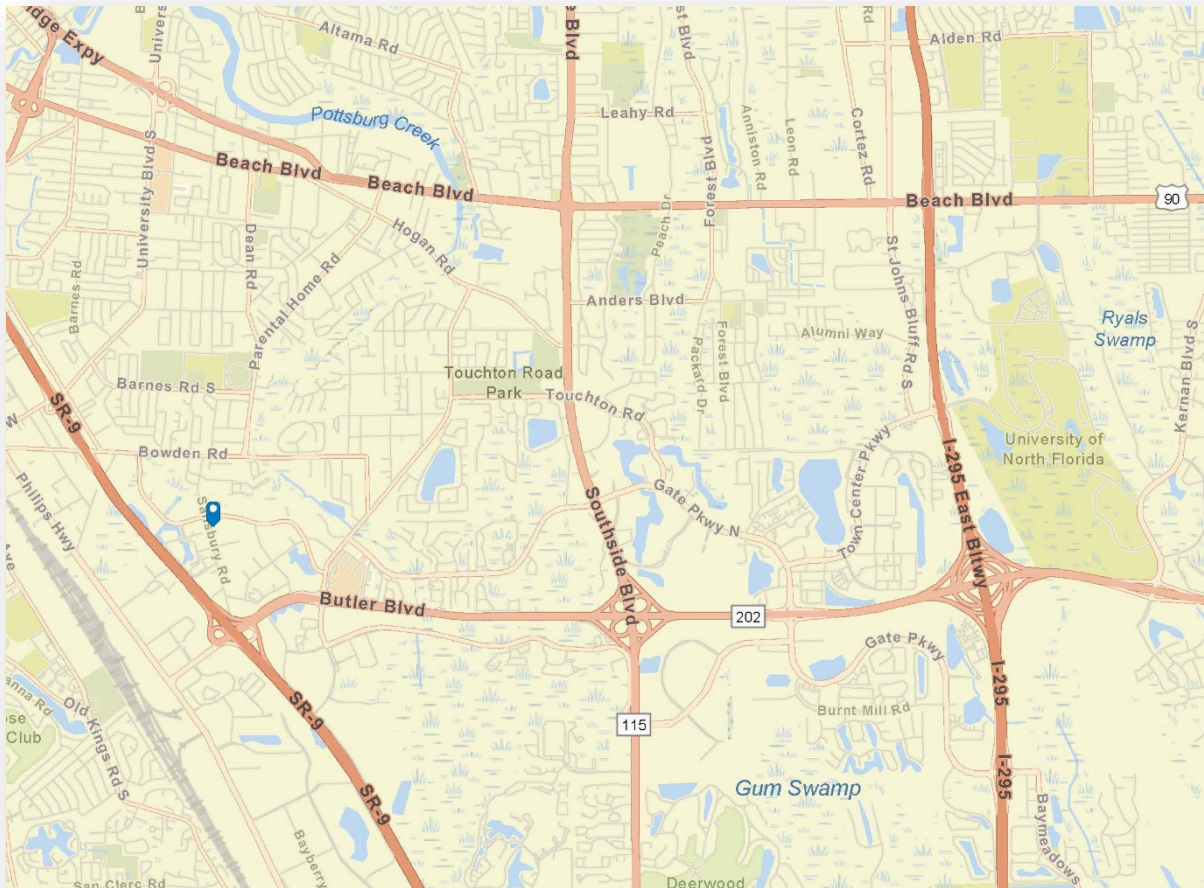

Building Plan

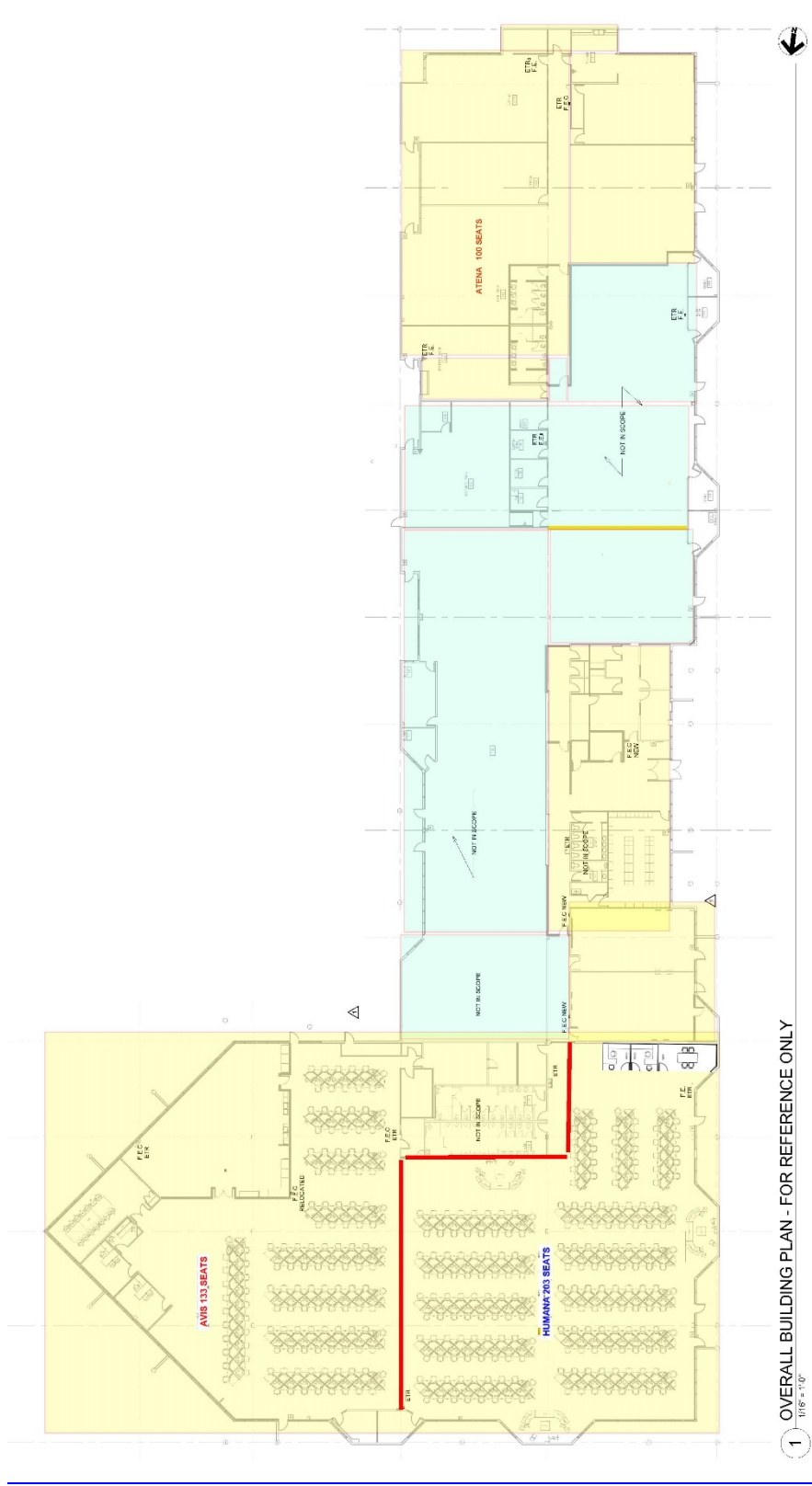

1 OVERALL BUILDING PLAN - FOR REFERENCE ONLY
1/8" = 1'-0"

30,070 SF SUBLEASE SPACE

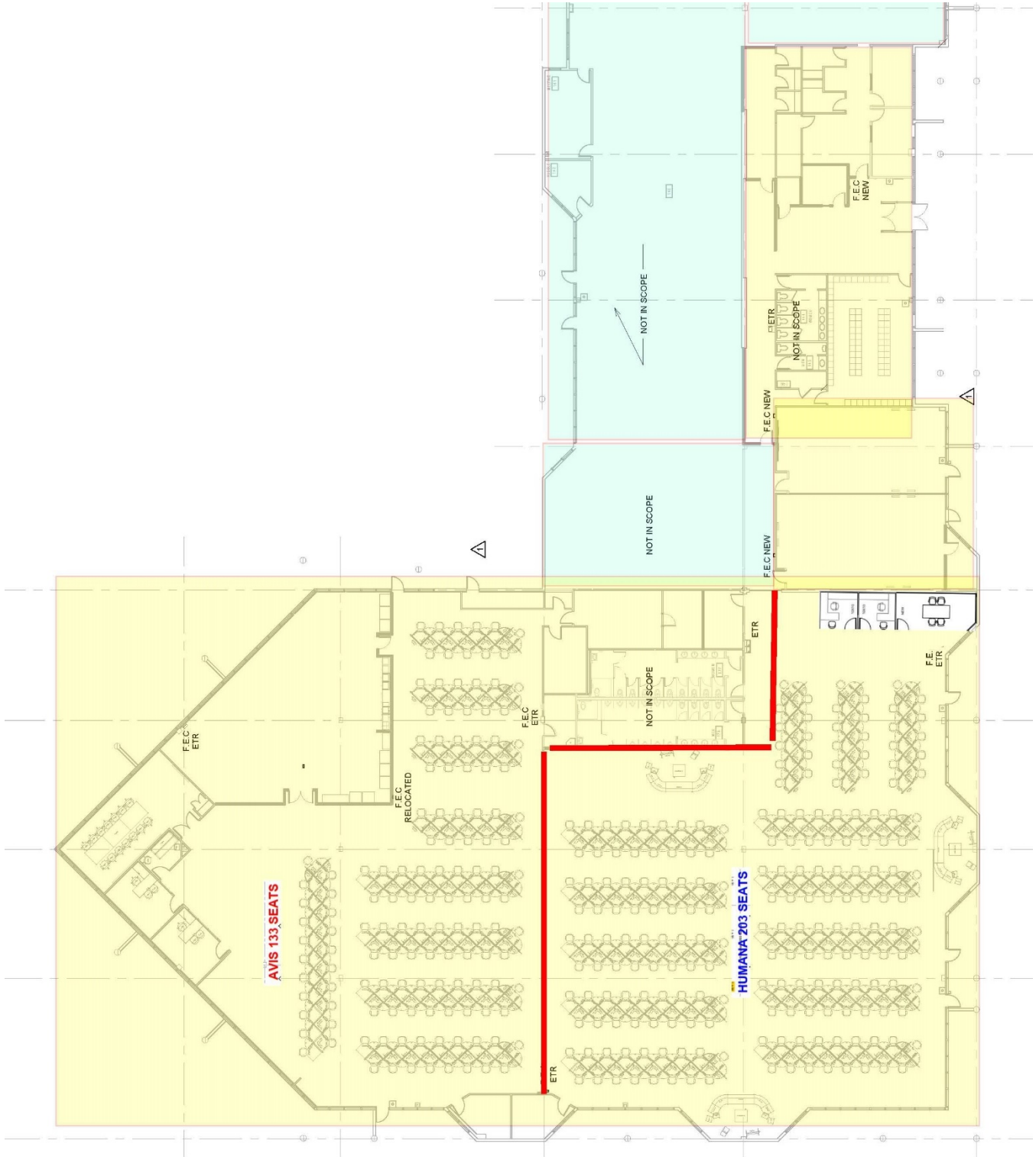

8,414 SF SUBLEASE PLAN

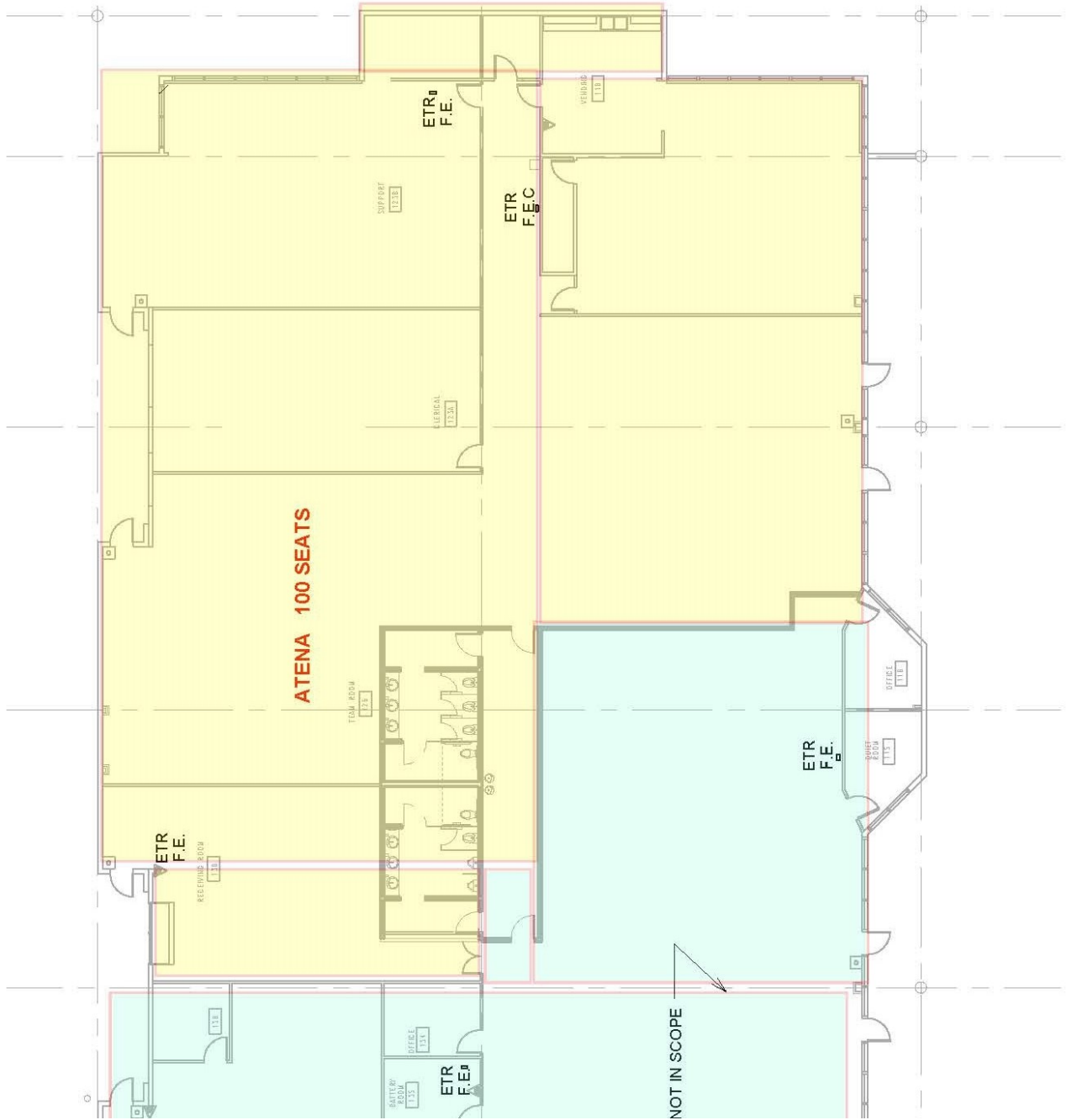

Garnett Commercial Real Estate, Inc.

7807 Baymeadows Road East, Suite 405, Jacksonville, FL 32256

904-855-8800 / jgarnett@ccim.net / www.jackgarnett.com

GARNETT
COMMERCIAL
REAL ESTATE, INC.



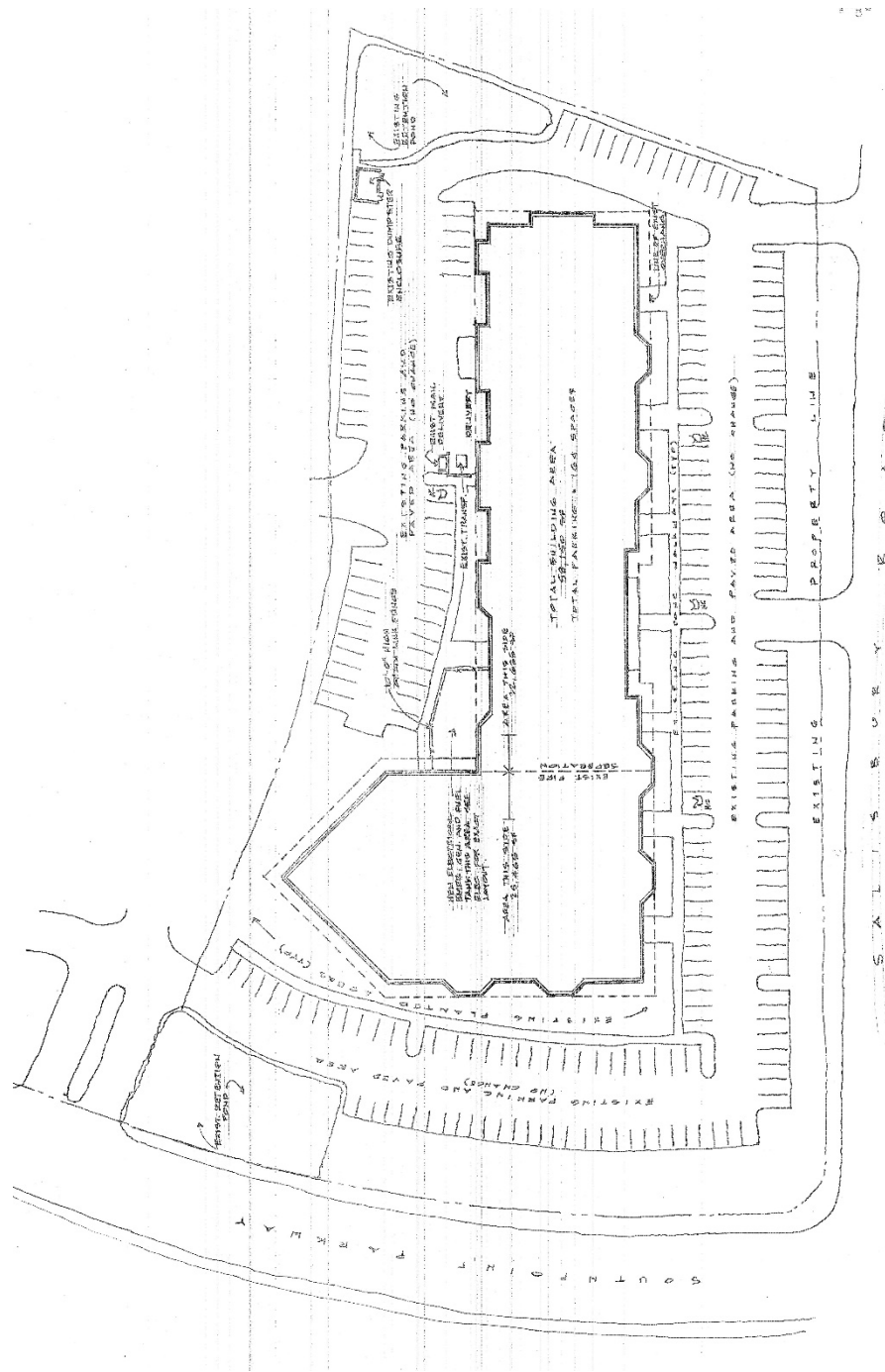

NOTES

1. INFORMATION SHOWN ON THIS PLAN TAKEN FROM THE RECORD PLANS FOR THE PROJECT.

SITE PLAN
Scale: 1/8" = 1'-0"

Garnett Commercial Real Estate, Inc.
 7807 Baymeadows Road East, Suite 405, Jacksonville, FL 32256
 904-855-8800 / jgarnett@ccim.net / www.jackgarnett.com
 A Licensed Real Estate Broker

Disclaimer: Details herein are believed to be correct; however, it is subject to errors, omissions, price change or withdrawal without notice.